

Rowenta

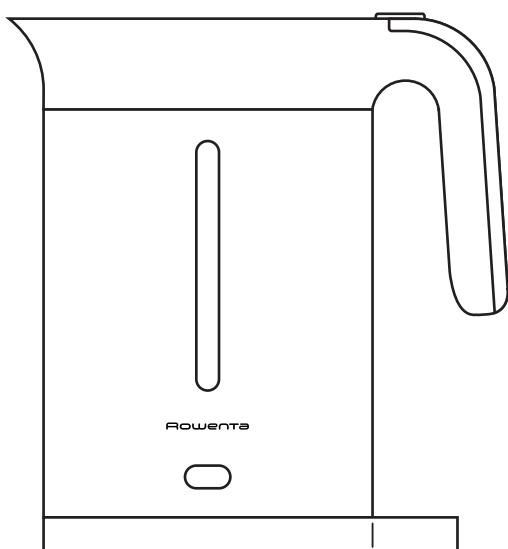

USE



Thank you for buying a Rowenta kettle. Read these instructions carefully, common to all our models, and keep them in a safe place.



To open the lid : press on the locking system button.

To close : press the lid down firmly.

- **Only boil water in the kettle**

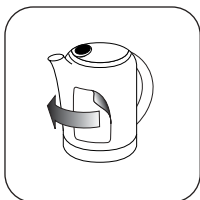

Remove all packaging, stickers or other accessories from the inside and outside of the kettle.

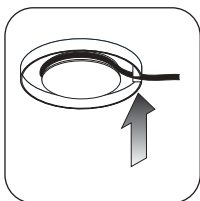

Adjust the length of the cord by winding it under the base. Wedge the cord in the slot.



Place the base on a smooth surface which is clean and cool. Place the kettle and its base towards the back of the working surface.

- **Do not place the kettle on or near surfaces which are slippery or hot and do not let the cord hang over a source of heat (hot plates, gas cookers). Keep away from children.**

- **The kettle must only be used with its original base.**

USE



Fill the kettle with the required amount of water.

You can fill the kettle through the spout to keep the filter in good condition.

At the very least, cover the heating element (or the bottom of the kettle) with water.

- **Never fill the kettle when it is on its base.**
- **Do not fill it above the max. level or below the min. level. If the kettle is overfilled, boiling water may escape.**
- **Do not use without water.**
- **Check that the lid is closed properly to avoid steam near the handle.**

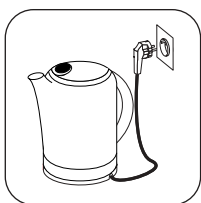

Place the kettle on its base.

Connect to the mains.

Check that the electrical supply is compatible with the power and voltage indicated beneath your model.

- **Only plug the kettle into a socket with a built-in earth connection.**
- **Never release the lid whilst the water is boiling.**

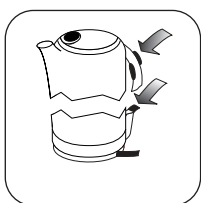

Turn it on using the switch on the handle. The kettle will turn itself off automatically when the water is boiling.

- **Never move the kettle when it is working**



Check that the kettle has stopped automatically or turn it off manually before removing it from the base to pour the water.

The first two or three times that you use the kettle, throw the water away because it may contain foreign particles.

Rinse the kettle and filter separately.

- **We recommend that you do not leave any water in the kettle after use.**

CLEANING



To clean your kettle

Unplug it. Leave it to cool and then clean with a soft damp sponge.

Kettles with ULTRAINOX concealed element :

These instructions are also valid for this type of kettle. However, the special highly polished stainless steel element never needs descaling.

Cleaning/Maintenance

As any build-up of scale will NOT affect the performance of the kettle, it does not need descaling. Simply rinse the kettle on a regular basis to remove loose scale from the walls and the element. If required, you can descale the inside walls of the kettle (follow guide-lines below).

- **Never wipe the element surface as this may damage it.**

To clean the filter (depending on model)

The removable filter is made up of fabric which retains the particles of scale and stops them from falling into your cup when you pour. This filter does not treat the water or remove the scale from it. It therefore preserves all the qualities of the water.

With very hard water, the filter becomes clogged with scale very quickly (10 to 15 uses). It is important to clean it regularly. If it is wet, rinse it with water, and if it is dry, scrub it gently. Sometimes the scale does not come away ; if so, descaling is necessary.

DESCALING

Descale regularly, preferably at least once a month and more frequently if your water is very hard.

To descale your kettle, use :

- white vinegar : fill the kettle with half a litre of vinegar. Leave to stand for 1 hour without heating
- citric acid : boil half a litre of water. Add 25g of citric acid and leave to stand for 15 minutes.
- a specific descaling agent for plastic kettles : follow the manufacturer's instructions.

Empty your kettle and rinse it 5 or 6 times.

Repeat if necessary.

To descale your filter (depending on model) :

Soak the filter in white vinegar or diluted citric acid.

Rinse thoroughly with water before putting back in the kettle.

- **Never use descaling methods other than those recommended.**

IN THE EVENT OF A PROBLEM

There is no visible damage to your kettle

The kettle does not work or stops before boiling.

- Check that the kettle is plugged in properly.
- The kettle has been operated without water or scale has accumulated, triggering the safety system to prevent dry operation: leave the kettle to cool, take it out of its base, then fill it with water and put it back on its base to reinitialize the safety system. Use the switch to turn it on : the kettle starts working again after a few minutes.

The water tastes of plastic

This usually occurs when the kettle is new. Throw away the water the first few times you use it. If the problem persists, fill the kettle to maximum, add two teaspoonfuls of bicarbonate of soda. Boil and throw away the water. Rinse the kettle thoroughly.

If your kettle has fallen, if it leaks, or if the cord, the plug or the base of the kettle are visibly damaged Return your kettle to your Rowenta After-Sales Service Centre, the only organization authorized to repair it. See warranty conditions and list of centres in the booklet supplied with your kettle. The type and serial number are indicated on the bottom of your model.

- **Do not use the kettle. No attempt should be made to dismantle the appliance or the safety systems.**
- **If the base of your kettle is assembled with screws and if the power cable is damaged, it must be replaced by the manufacturer, its after-sales department or a person with similar qualifications for safety reasons.**
- **If the base does not include any screws, the power cable cannot be replaced. If the cable, the base or the connector are damaged, the base must be replaced completely.**
- **Rowenta reserves the right to modify the characteristics or components of its kettles at any time, in the interests of consumers.**

This product has been designed for domestic use only. Any professional use, inappropriate use or failure to comply with the instructions, the manufacturer accepts no responsibility and the guarantee will not apply.

PREVENTION

OF ACCIDENTS IN THE HOME

- **Do not leave the appliance within the reach of children. The use of this appliance by children or handicapped people should be avoided unless under supervision.**
- **Take care if carrying the kettle when it contains hot water.**
- **Tilt and pour slowly in order to prevent any risk of burning with hot water.**
- **Keep your hands away from the pouring lip when the water is coming to the boil, and avoid any contact with the hot surfaces of the appliance.**

Ref. 2014227160