

Rowenta

EXPERTISE

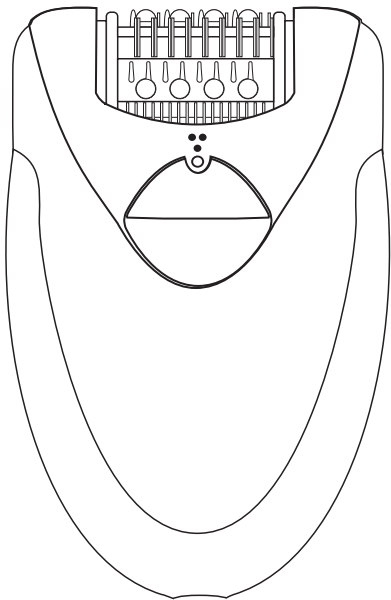

Gebrauchsanweisung

Instruction for use

Notice d'emploi

Istruzioni per l'uso

Modo de empleo

Modo de utilização

Kullanım kılavuzu

Инструкция по использованию

1- DESCRIPTION OF YOUR APPLIANCE

1. Cap
2. Depilator head SOFT-PRECISION
3. Hair guides
4. Tweezers
5. Massaging beads
6. 2-speed and stop switch
7. Adaptor
8. Cleaning brush
9. Cleaning brush
9. Micro-peeling head
10. Peeling patch
11. Sensitive Area head

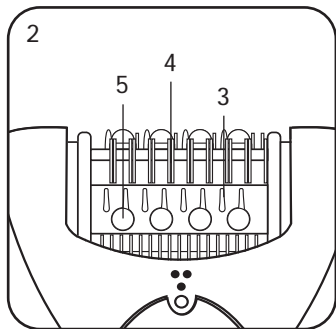
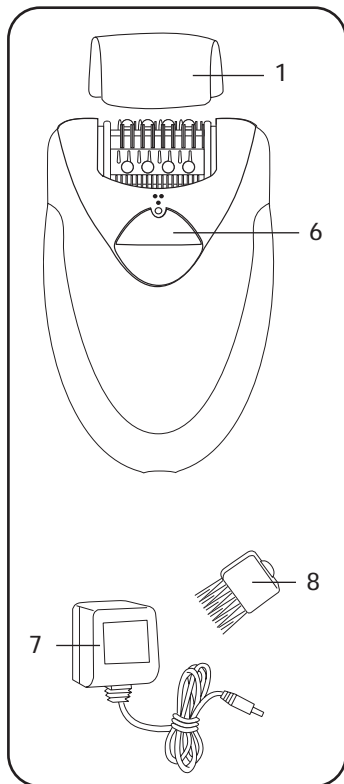

Pain-free function:

Your appliance is equipped with a roller beads massaging system integrated into the depilation head. The roller beads massage the skin to reduce the sensation of pain linked to depilation.

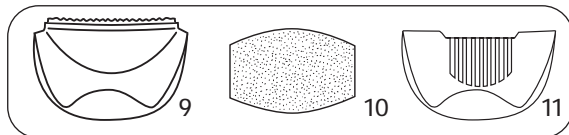

2 - SAFETY

GB

Voltage : Ensure that this voltage corresponds to that of your mains supply. Incorrect connection may cause irreparable damage which is not covered by the guarantee.

- This appliance is intended for personal domestic use only.
- It must only be used with the enclosed adaptor EM2A1 or EM2A2.
- Never use if the appliance (depilator or adaptor) is damaged or in the event of any damage caused by dropping the appliance (invisible damage may be dangerous).
- This appliance can only be repaired using special tools. In the event of any after sales problem (depilator, adaptor), please consult an approved service agent (see enclosed leaflet).
- We decline any responsibility for damage arising from incorrect use of the appliance or use of the appliance in any way other than that specified in these instructions.
- When the depilator is in use, it must not come into contact with eyelashes, hair, clothes or any other objects, in order to avoid any danger of injury or blockage.
- Keep a careful eye on the appliance if used on, or in the presence of children or invalids.

- Do not use the depilator:
 - on your face
 - on broken, burnt or sore skin
 - on sensitive areas (varicose veins, moles, birthmarks, warts...)
 - if you suffer from skin complaints, (eczema, inflammations, acne...)
- For hygiene reasons, it is advised that you do not allow anyone else to use your appliance.

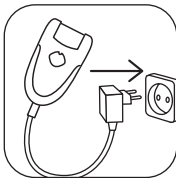
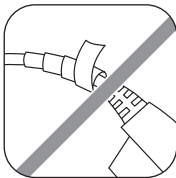
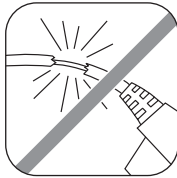
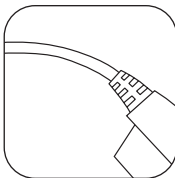
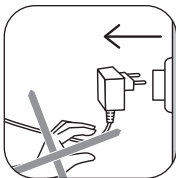
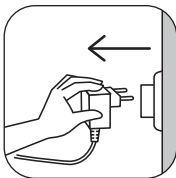

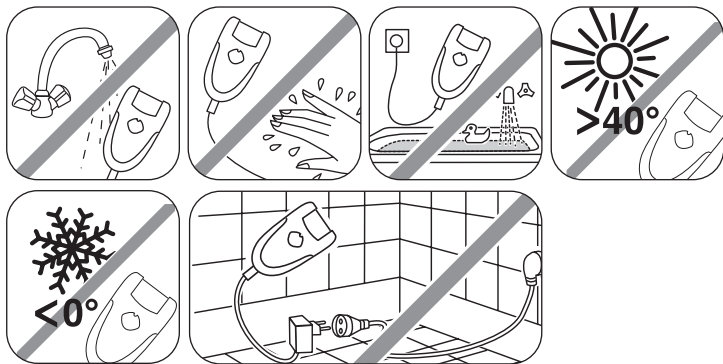

3. PREPARATION OF THE SKIN

- Your skin must be clean and dry.
- Do not apply either cream or hydrating milk before depilation.
- If you previously used a razor for depilation:
 - the first few times you use the epilator, your skin may feel more sensitive, as shaving has made your hair thicker and stronger. This sensation will lessen the more you use your epilator : the hair will grow back less quickly and become thinner.
- Your epilator will be much more effective and easier to use if you use it regularly.

We advise you to use your epilator as soon as your hair starts to grow back.

4. CONNECTION

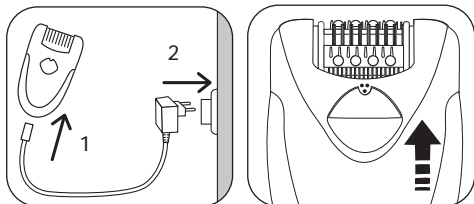

5. STOPPING THE APPLIANCE

GB

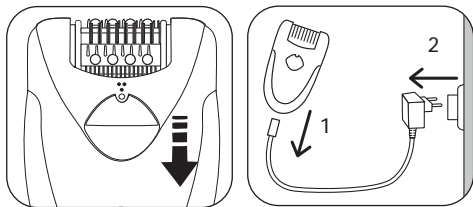

6. PEELING

Peeling will enable you to:

- Raise the hair beforehand for more effective removal.
- Limits growth of subcutaneous hair if practised regularly.

For these reasons, it is advised that you use Expertise and its Micro-peeling :

- facility just before shaving and
- regularly once a week between shaving sessions.
- The sensitivity of the peeling patches to the skin has been dermatologically tested. Nevertheless slight, superficial marks may appear on the skin following exfoliation but these will disappear quickly.

- You are strongly advised not to use micro-peeling just after shaving to avoid damaging your skin.
- And not to use a peeling gel or cream at the same time.
- Never carry out peeling on sensitive areas (armpits / bikini line / face).

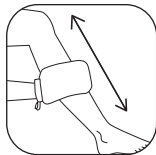

- After peeling, we advise you to wipe over the area with a moist flannel to remove any dead skin. Dry the skin thoroughly afterwards.

Method :

Clip on the peeling patch.

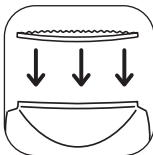

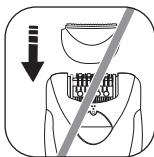
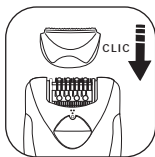

- Push the Micro-peeling head in until you hear the click.



- Move the switch to the on position "•••"

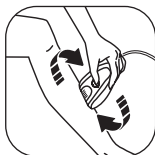

- Carry out peeling slowly and without pressing, using a circular movement.

When using the Micro-Peeling function for the first time or if your skin is very delicate, we recommend:

1. skin is wet before peeling, use cotton wool or a flannel to do this
2. making slow and gentle rotating movements when using the appliance

3. not to use the appliance more than twice on the same area.

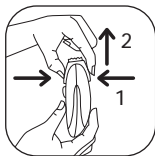

- Remove.

7. LEG HAIR REMOVAL

- Move the switch to the on position "•••"

- The switch must always remain visible during use.

- Shave against the lie of the hair, slowly and without pressing, with the shaver perpendicular to your skin.

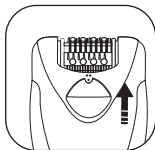

8. HAIR REMOVAL FROM SENSITIVE AREAS

GB

Preparing the area where you want to remove hair:

If the hairs are long trim to approximately 1cm.

Dry the area thoroughly to ensure any trace of deodorant or perspiration are removed.

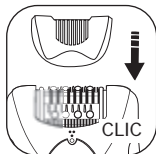

- Push the Sensitive Area head accessory in until you hear the click.

The combs must be on the same side as the switch.

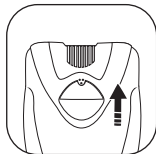

- Move the switch to the on position "••"

Shave against the lie of the hair, slowly and without pressing, with the shaver perpendicular to your skin.

Important :

- Keep your arm raised and stretched throughout the hair removal process.
- Stretch the skin to make it easier.

For the armpits:

First from bottom to top ...

... Then from top to bottom.



For the bikini line:

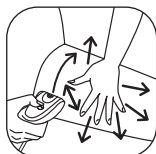

Important: Make sure the skin is stretched properly.

After use, remove the head.

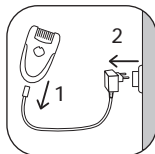
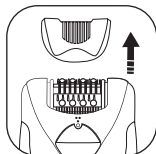

9. CLEANING THE APPLIANCE

GB



- For more thorough cleaning, clean the tweezers with a cloth soaked in alcohol, turning the depilation head manually.

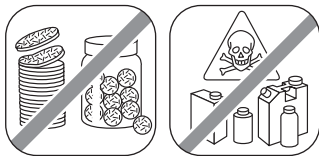

Do not apply alcohol to the body of the appliance to avoid its colours changing.

Cleaning the Sensitive Area head:

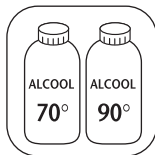

Cleaning the Micro-peeling head:

It is recommended to change the peeling patch every three peeling sessions or when it becomes worn.



10. SKIN CARE

Small red spots may appear. They will disappear quickly. For s preferable to use your depilator in the evening.
If necessary, apply calming cream after depilation.

11. PROTECTION OF THE ENVIRONMENT

At the end of the life of your product, it should go to a specially-adapted waste recycling centre.

